

MCPUPRO CPU COOLER

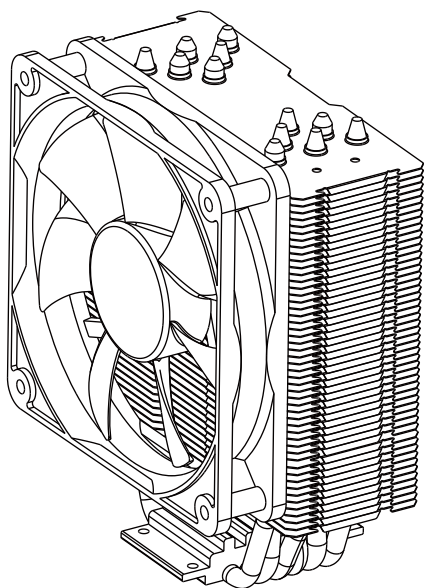

WWW.MARSGAMING.EU

PRODUCT OVERVIEW

- | | |
|-----------------|--------------------|
| 1 Back Plate | 4 AMD Bracket |
| 2 Bracket Screw | 5 Thermal Grease |
| 3 Intel Bracket | 6 LGA 2011 Bracket |

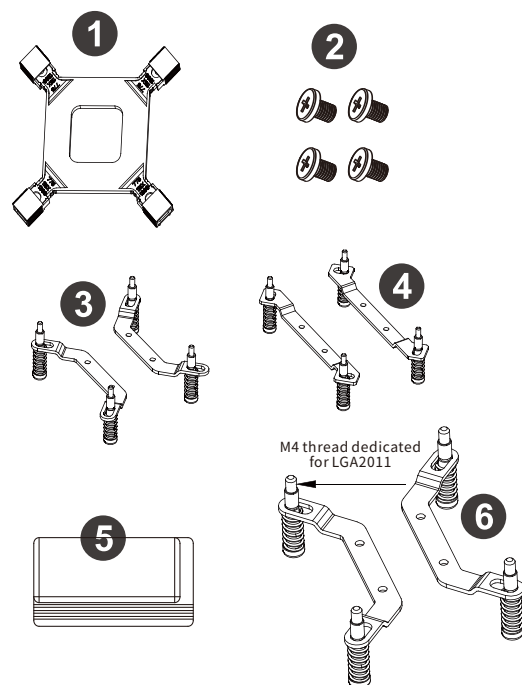

INTEL INSTALLATION

STEP 1: Please remove the fan before installing radiator by opening the buckles pointed by the arrow.

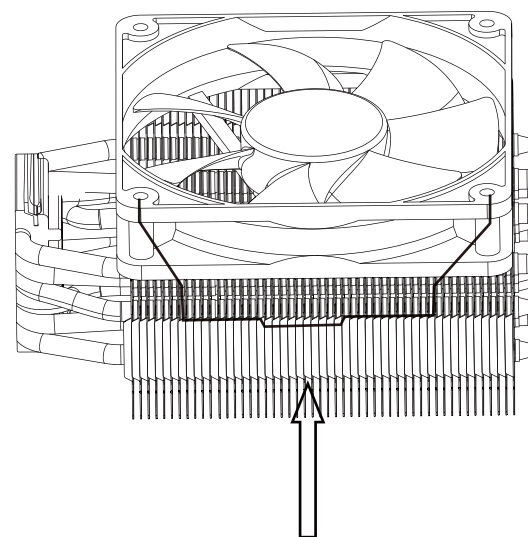

INTEL INSTALLATION

STEP 2: Install the bracket mount on the cooler base and fasten the screws.

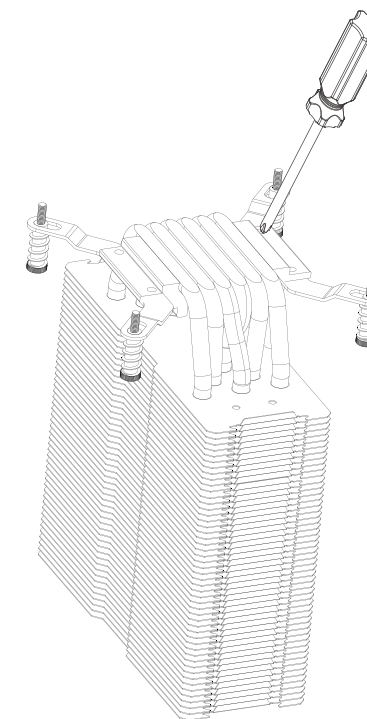

INTEL INSTALLATION

STEP 3: Evenly spread the heatsink paste on the surface of the CPU and remove the plastic protection.

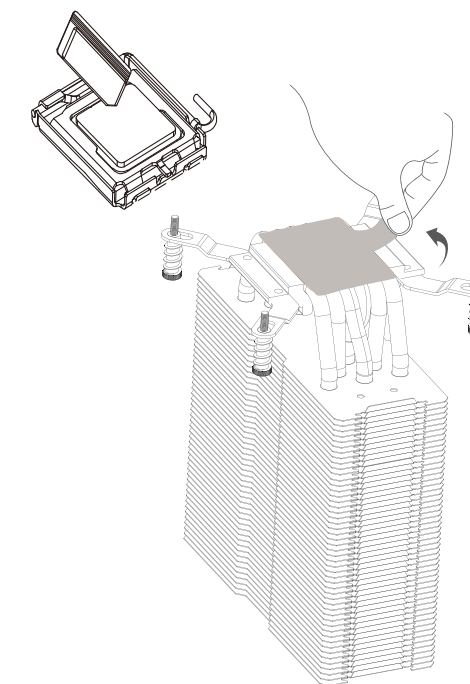

INTEL INSTALLATION

STEP 4: Move the bracket screw to the corresponding position according to the motherboard socket type.

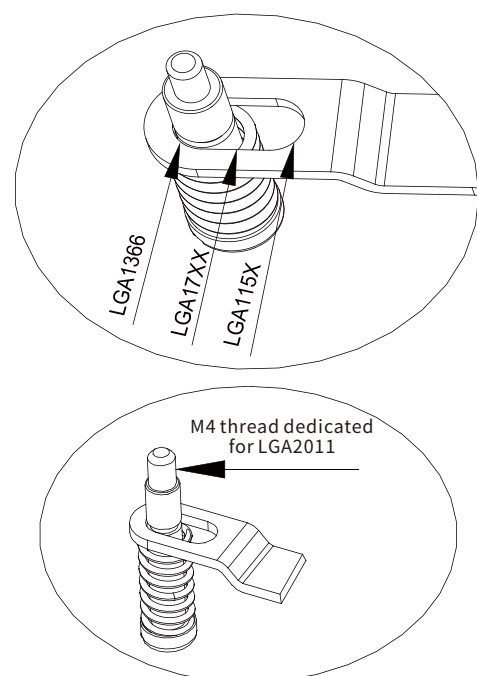

INTEL INSTALLATION

STEP 5: Move the backplate slider to the corresponding motherboard socket LGA115X/17XX/1366, if the motherboard socket is LGA2011 use the original motherboard backplate.

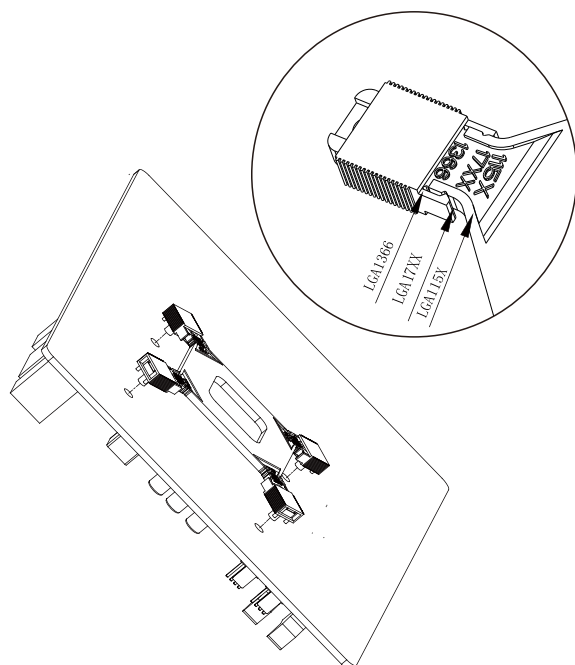

INTEL INSTALLATION

STEP 6: Place the radiator on the CPU and screw the backplate to the bracket mount.

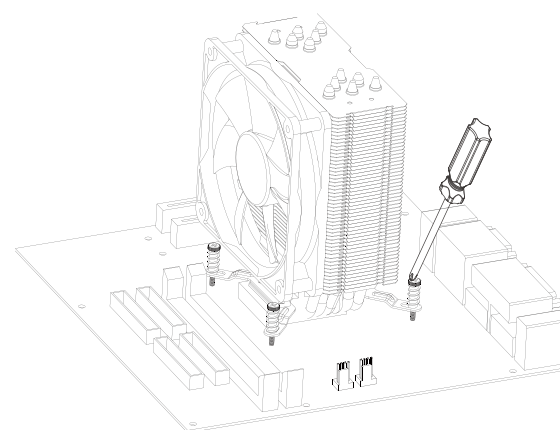

INTEL INSTALLATION

STEP 7: After installing the fan, connect the PWM cable to the CPU-FAN connector of the motherboard.

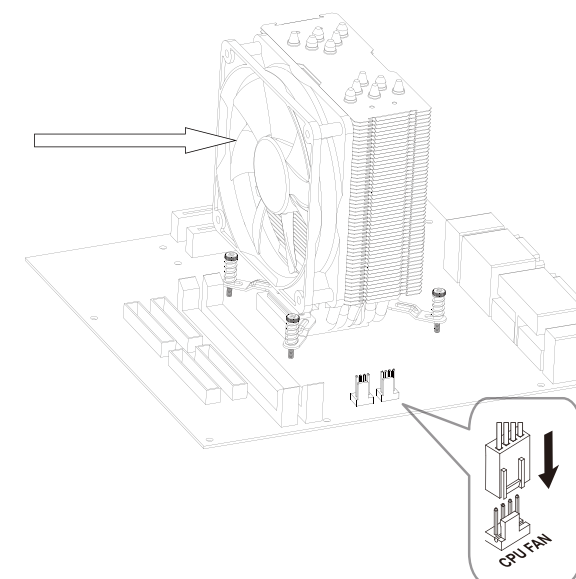

WWW.MARSGAMING.EU

AMD INSTALLATION

STEP 1: Please remove the fan before installing radiator by opening the buckles pointed by the arrow.

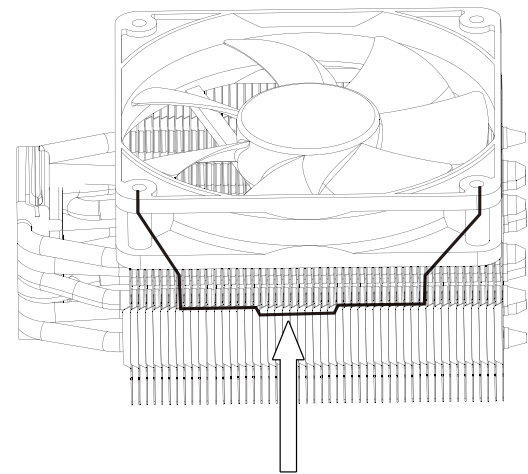

AMD INSTALLATION

STEP 2: Install the AMD bracket mount on the cooler base and fasten the screws.

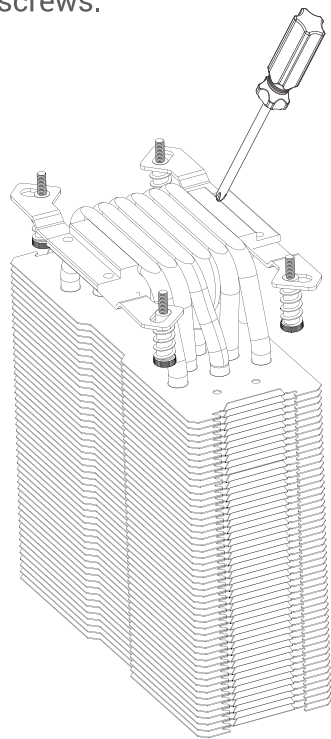

AMD INSTALLATION

STEP 3: Remove the upper bracket on the AMD motherboard.

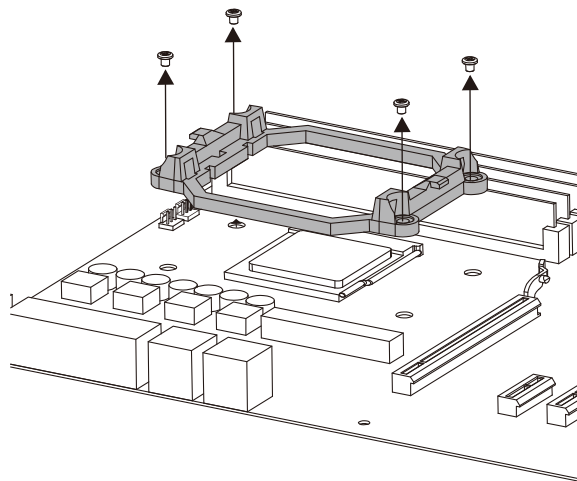

AMD INSTALLATION

STEP 4: Evenly spread the heatsink paste on the surface of the CPU and remove the plastic protection.

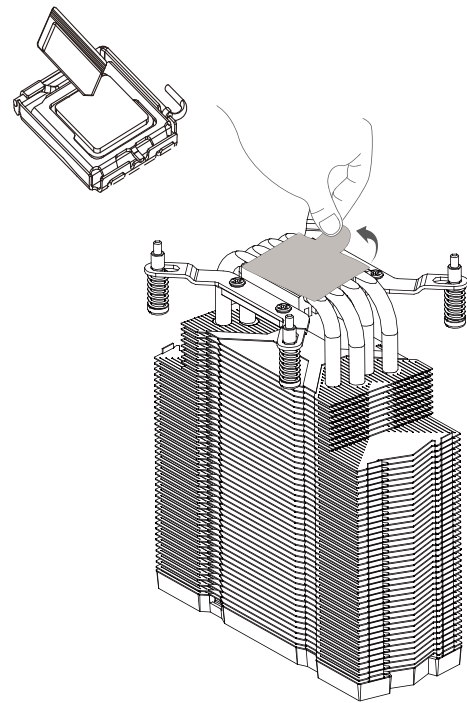

AMD INSTALLATION

STEP 5: Move the screw on the bracket to the corresponding position according to the motherboard socket type.

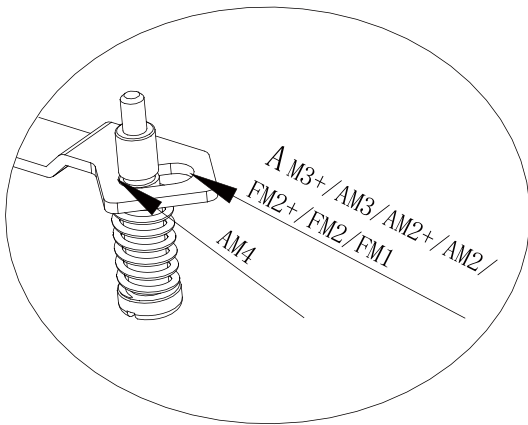

AMD INSTALLATION

STEP 6: Place the radiator on the CPU and screw the backplate to the bracket mount.

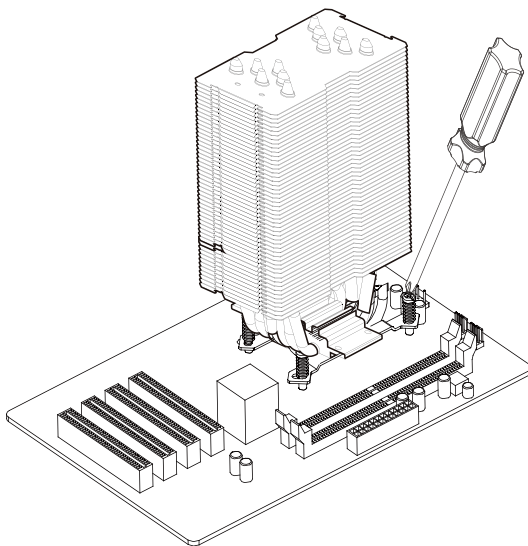

AMD INSTALLATION

STEP 7: After installing the fan, connect the PWM cable to the CPU-FAN connector of the motherboard.

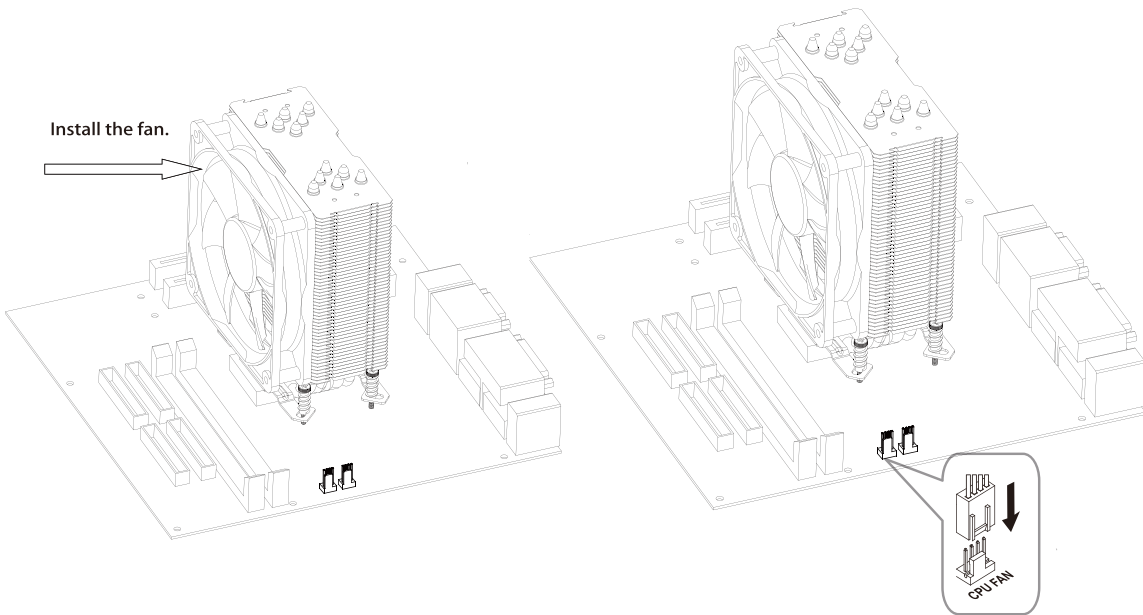

From Mars Gaming team:

we want to thank you for the purchase of this product!

We try to improve everyday to offer the best service and the best quality on our peripherals. Thank you for your trust!

ARE YOU HAPPY WITH YOUR PURCHASE?

YES



Rate us in your marketplace and share your experience in your social media



@MarsGaming_
marsgaming
MarsGamingOfficial

NO

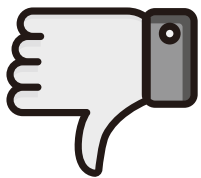

Please contact our technical support service by sending an e-mail to



support@marsgaming.eu